

LET'S DO BUSINESS

It's our business to make your business offsite run perfectly. No other meeting has exactly your requirements, and no other venue will match them like Penta. We take it personally.



DAY DELEGATE PACKAGE "PENTA"

- Meeting room hire
- Relaxing morning break
- Quick-Lunch
- Relaxing afternoon break
- Equipment (conference kit, flipchart, projector, notepads & pencils, screen)
- Unlimited mineral water in the main meeting room and during lunch



DAY DELEGATE PACKAGE "PENTA PLUS"

- Meeting room hire
- Relaxing morning break
- 3 course lunch menu or lunch buffet* with 3 main courses available
- Relaxing afternoon break
- Equipment (conference kit, flipchart, projector, notepads & pencils, screen)
- Unlimited mineral water and fruit juices in the main meeting room and during lunch
- Unlimited soft drinks during lunch and breaks

* From 30 persons

PENTAFACTS IPSWICH

- 126 rooms
- 2 conference rooms / 40 people
- 25 parking spaces
- Pentalounge open 24 h
- Free WIFI available
- Gym
- Free Pay-TV
- Free billiards & latest game console

LOCATION

- Stansted Airport 77 km
- Ipswich station 0.5 km
- Ipswich Town Football Ground 0.5 km
- City centre 2 km
- Waterfront 1 km

CONTACT

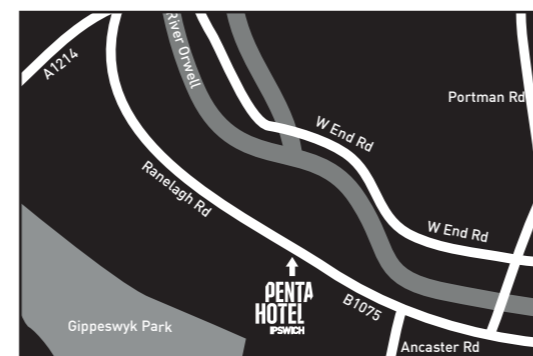

Pentahotel Ipswich
Ranelagh Road · Ipswich IP2 0AD
T: +44 (0) 1473 694 600 + opt. 4 · F: +44 (0) 1473 694 610
info.ipswich@pentahotels.com

PENTAHOTEL



BETTER BUSINESS EVENTS SWITCH TO IPSWICH

Perfectly formed with business events for up to 40 people in mind, Penta Ipswich redefines a successful outcome. We've got the tech you need, and a can-do attitude comes as standard. Enlist an outstanding team today. Call Penta...



WORK, PLAY, COMPETE

We're good at blurring the lines between business and leisure. Call it a Penta philosophy: add relaxation to work and a little tension to fun. It makes for great results.



OF COURSE WE MAKE SURE
IT'S YOUR PERFECT EVENT -
IT'S OURS TOO.



SPACE TRAVELLERS

A room of one's own. Complimentary Sky TV, large flatscreen, free WIFI... all in your own designer-styled room. That, dear guest, is unwinding the Penta way.

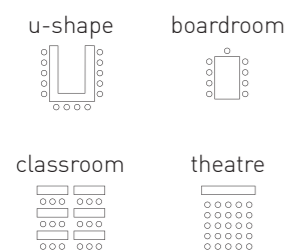
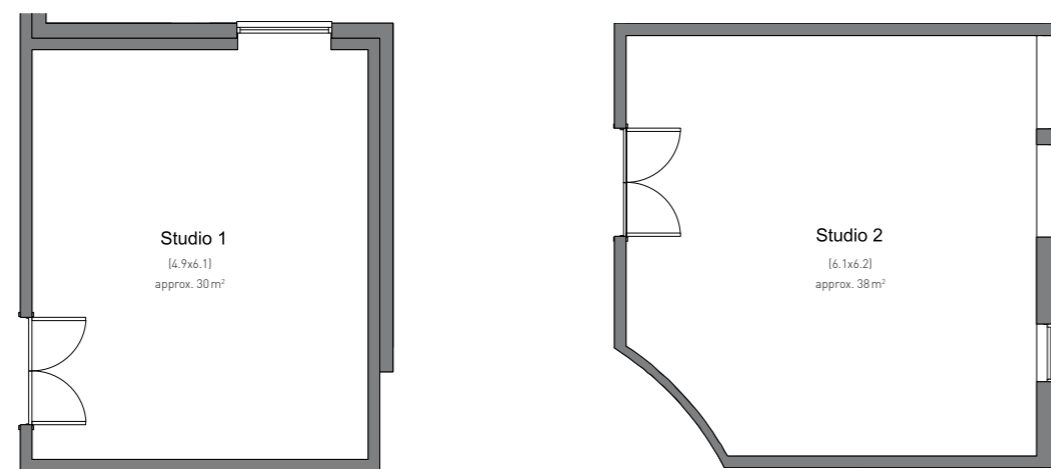

		u-shape	banquet	classroom	boardroom	theatre
STUDIO 1	(30 m ²)	12	10	16	11	20
STUDIO 2	(38 m ²)	18	20	20	20	40



APRÈS BUSINESS...

You are our guest. We think about your comfort a great deal more than you'd imagine. If you know our Pentalounge, you know we mean it. Style and relaxation have never collided so elegantly. Go ahead, unwind. Utterly.



APPETITE FOR EXCELLENCE

Quality input means quality output, and what business runs on an empty stomach? We certainly don't. That's why we use top quality ingredients, like 100% black angus beef for our burgers and the best Argentine and American steaks. We didn't think you'd want less.